

FIXCLIP

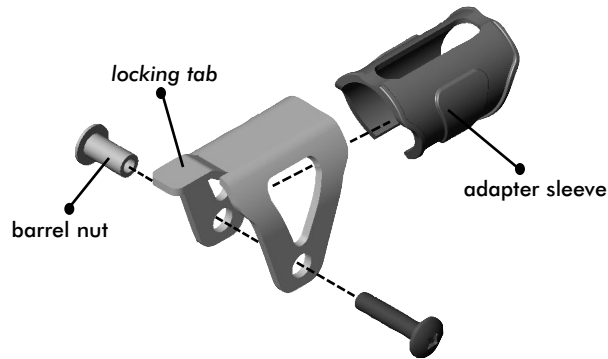

The **FixClip** (x2) is a locking device designed to hold the rear hooks of a wheelchair seat (drop-base) cushion securely onto the wheelchair seat frame. By positioning the 'locking tabs' over the **rear** drop hooks, the FixClips will effectively secure the drop hooks/ seat cushion in place. **Note:** FixClips are intended to be used in combination with our "lock & release" DuraClips¹; Two DuraClips are installed at the front of the seat cushion to secure the front drop hooks to the wheelchair seat frame.

FIXCLIP INSTALLATION INSTRUCTIONS:

1. Position the wheelchair seat (drop-base) cushion in the desired fore/aft position on the seat frame tubes and snap the seat (drop hooks) into place.

2. Working at the rear of the wheelchair seat, install a FixClip onto each seat tube (left and right) as illustrated in image A.

Important! - to function properly, the FixClips must be installed behind the rear drop hooks with the locking tab facing toward the front of the wheelchair.

3. If the wheelchair uses 7/8" (22 mm) diameter seat tubes, ensure the adapter sleeves are installed as indicated.

4. Adjust each FixClip so that it rests up against the rear drop hooks with the 'locking tab' positioned over top of the hook. Secure the FixClips to the seat tube/ frame using the mounting hardware provided* -see image B and C.

***note:** tighten hardware until the clip is snug on the seat tube- **do not overtighten!**

5. With both rear FixClips properly secured, the front drop hooks may now be secured using two DuraClips¹ as illustrated in image C.

¹**note:** Please refer to the **DuraClip Installation Manual** (provided separately) for detailed installation instructions.

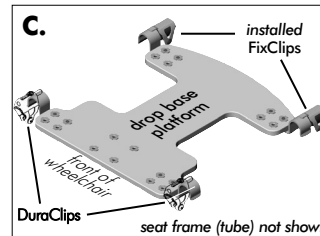
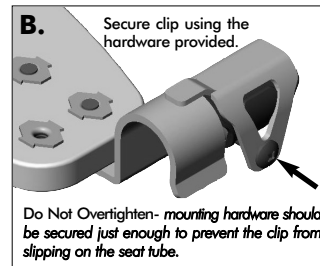
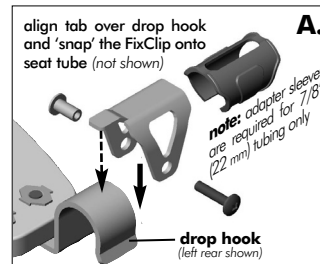

FixClip

Installation Manual



U.S.: 700 Ensminger Rd., Suite 112, Tonawanda, NY 14150
TOLL FREE TEL: 1.888.433.6818 TOLL FREE FAX: 1.888.433.6834

Canada: 84 Citation Dr., Concord, ON L4K 3C1 Canada
TOLL FREE TEL: 1.866.748.7943 FAX: 905.695.0138

